



**Installation Guide**  
**722624044 G3**

---

---

**CashFlow® 690 Series  
Change giver Installation Guide**

Part No. 722624044  
Version: G3  
Publication date: August 2006



Published by:

MEI

Internet: <http://www.meigroup.com>

**©, MEI UK International Ltd., 2006**

Except as permitted under the relevant local legislation, no part of this publication may be copied, transmitted, transcribed, or distributed in any form or by any means, or stored in a database retrieval system, or translated into any language (natural or computer), without the prior permission of MEI.

MEI reserves the right to change the product or the product specifications at any time. While every effort has been made to ensure that the information in this publication is accurate, MEI disclaim any liability for any direct or indirect losses (howsoever caused) arising out of use or reliance on the information included in this Installation Guide.

This document does not necessarily imply product availability.

For information about the availability of translated versions of this Installation Guide, please write to the Technical Service Manager at the above address.

MEI®, CashFlow® and the MEI device are registered trademarks.  
Copyright MEI 2006.

## Safety

### National and International Standards Conformance

CashFlow® 690 Series products operate at Safety Extra Low Voltage Level (SELV) as defined in IEC335/EN60335 '*Safety of Household and Similar Appliances*'. They may be designed into equipment complying with IEC335/EN60335 or IEC950/EN60950 '*Safety of Information Technology Equipment*'.

CashFlow® 690 Series products are of Class 2 construction.

### Rated Operating Voltage

The operating voltage of a CashFlow® 690 Series Changeover is stated on the label attached to the product. It must not be used with any power source other than that indicated.

### Dangerous Environments

The CashFlow® 690 Series Changeover must not be operated in the presence of flammable gasses, fumes or water.

### Product Disposal

Do not dispose of any part of a CashFlow® 690 Series Changeover by incineration.

## Before You Begin



### 1 TURN OFF THE POWER SUPPLY TO THE VENDING MACHINE

### 2 Visually check that the vending machine is upright, both from the front and side

If the vending machine is not upright, this can affect the coin acceptance performance of the Change giver.

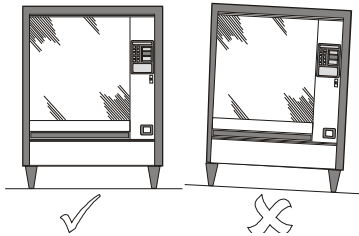

### 3 Check the product voltage

You will find this information on the label attached to the Change giver.

Be sure that the Change giver voltage is the same as the voltage supplied by the vending machine.

Ensure that there are no loose packaging materials obstructing the coin path of the change giver.

## Fixing

To fix the Change giver, the only tool you need is a medium size screwdriver.

The Change giver has three fixing keyholes as shown below.

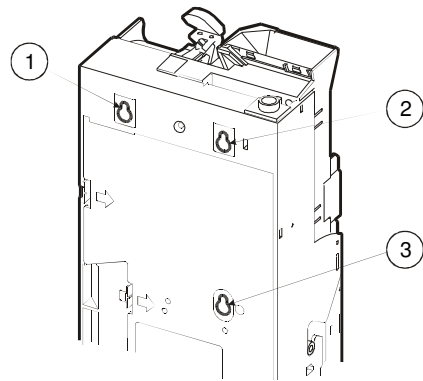

The vending machine is generally fitted with three screws in matching positions. Alternatively, there may be two location studs and one screw, or a similar arrangement.

To fix the Change giver:

- 1 Partly unscrew any screws fitted to the vending machine so that the distance between the underside of the screw head and the vending machine panel is approximately 4mm

- 2 Locate the Change giver on the screws or studs, ensuring that it is flat against the vending machine
- 3 Tighten the upper right-hand screw. (looking from the front). You can access the screw through the hole in the keypad assembly

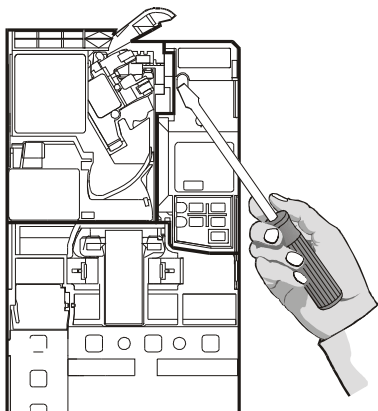

## Installation Checks

- 1 Check that when the Changer is idle there is a small gap (dimension X) between the lever on the vending machine and the lever on the Changer

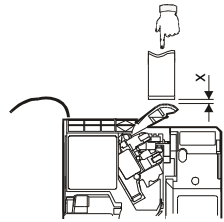

- 2 Check the alignment of the coin chutes

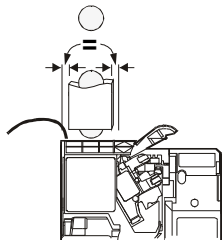

Insert two coins of each denomination into the vending machine and check that they cleanly enter the Changer acceptor and exit from the Changer into the cash return cup

## Power Connection

- 1 Plug in the Change giver power lead to the vending machine (and also the comms and display cables if applicable – see below)

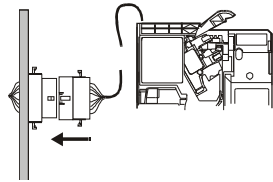

The Change giver can be supplied fitted with up to six cables. Normally only one of the end connectors will match the power socket on the vending machine, this being the power lead

If the vending machine has a comms socket, or a display jack, there will be cables attached to the Change giver with matching connectors which you must also plug in

- 2 Tuck the unused cables away tidily

Make sure they will not be trapped when the Change giver lever is pressed or when the vending machine door is closed.

- 3 Switch on the power to the vending machine



- 4 Check that after an initial red, amber, and green sequence, the light on the Changegiver keypad settles to green

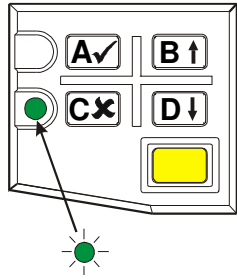

A green light indicates the Changegiver is functioning correctly.

✓ **The installation is now complete**

## Peripheral Connection

The CashFlow® 690 series change giver can also be fitted with an MDB (6 way male) peripheral connection that allows a Card reader or Bank note reader to be connected.

On the CashFlow® 690 series change givers, power to the peripherals is supplied directly from the change giver.

When using a CashFlow® 691 or 694 series change giver, power to the peripherals is supplied using a suitable power source from the vending machine. (For more information, contact your regional support centre)

**NOTE:** - Before you can connect a peripheral, ensure that the power to both vending machine and change giver is switch off.

Ensure that you connect the Card reader or Bank note reader into the peripheral loom and **Not** to the existing MDB loom fitted to the change giver.

## Troubleshooting

- **If a red light comes on**

The Change giver has a fault. Remove it by reversing the installation process and fit another one.

- **If a red/green flashing light is seen**

The Change giver has a fault. Remove it by reversing the installation process and fit another one.

- **If a flashing amber light is seen and coins are not accepted**

Ensure that the vending machine is upright.

Ensure there are no loose packaging materials, which may be obstructing the coin path inside the change giver

If the amber light still flashes after the above checks remove it by reversing the installation process and fit another one.— see page 4.

- **If an amber light comes on**

Check the comms cable (if fitted) is secure. If it is, the vending machine has a fault. Tell the vending machine operator.

- **If no light comes on**

1. Check the cable connection between the Change giver and the vending machine is secure
2. Visually check the power supply to the vending machine – there may be a power-on light or other indication



If there appears to be a power supply problem, tell the vending machine operator.

## Product support

In addition to the MEI offices around the world, an international network of Distributors and Approved Service Centres can offer you technical support and other services as well.

These services include repairs, re-programming of your CashFlow® products with new coinsets, replacing damaged modules, and the supply of a range of spare parts.

**[WWW.MEIGROUP.COM](http://WWW.MEIGROUP.COM)**