



Operating and Installation Manual

- English -

Revaluation Unit



Release 2.3 - May 2004

The manufacturer reserves the right to modify, without prior notice, the characteristics of the equipment described in this publication; and further declines to accept any responsibility for any inaccuracies contained in this publication which can be ascribed to printing and /or transcription errors.

All instructions, drawings, tables and information contained in this publication are confidential and can neither be reproduced, completely or in part, nor be transmitted to third parties without the written permit of the Manufacturer, who has the sole ownership.

ENGLISH

ZIP REVALUATION UNIT – Keys / Cards Loader “ZIP”

Operating and Installation Manual

INTRODUCTION

This technical documentation is part and parcel of the machine. Therefore, it must always follow the machine when it is moved or when the ownership is transferred, so that different operators may be able to consult it.

Before installing or using the machine, it is necessary to carefully read and understand the instructions contained in this manual, as they offer important information for safe installation, use and maintenance.

Any operation must be carried out exclusively by personnel who have a specific knowledge of the machine functions.

IDENTIFICATION OF THE MACHINE AND ITS CHARACTERISTICS

Every machine is identified by its own MODEL and SERIAL NUMBER, indicated on the rating plate attached inside the cabinet on the front side and visible when the door is opened.

This plate is the only acknowledged by the manufacturer as identification of the machine and carries data which safely gives technical information supplied by the manufacturer.

It is, therefore, recommended that this plate be neither damaged nor removed.

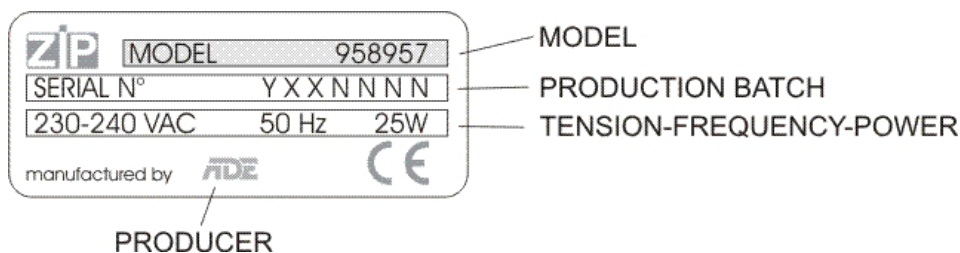

⚠ WARNING

There are two additional security labels (triangle shaped with a black symbol see Fig. 1, with a lightning bolt on a yellow background) placed on the security covers.

Do not remove or damage these two labels.

The removal of these security covers must be handled only by qualified personnel and only after having unplugged the electrical plug (it is not sufficient to turn the machine OFF – 0 symbol -).

Fig. 1



WARNING FOR SCRAPPING

Whenever the machine is to be scrapped, the laws in force regarding environment protection should be strictly observed. Ferrous and plastic materials and the like are to be disposed of in the authorised areas only.

TECHNICAL SPECIFICATIONS

INSULATION LABEL	:	1
POWER SUPPLY VOLTAGE	:	230/240 VAC
POWER SUPPLY FREQUENCY	:	50 Hz
MAX POWER INPUT	:	25 W
FUSE IN THE POWER SUPPLY LINE	:	2 x 0,2 A T
DIMENSIONS W x H x D (mm.)	:	500 x 650 x 250
WEIGHT (Kg)	:	26

MAIN FEATURES

- Lets you recharge Keys/Cards with banknotes or coins, depending on the acceptor installed.
- Can supply Bonuses, by installing the (optional) RAM expansion in the CPU module.
- Memorises the Statistics of the charged credit.
- Lets you use the “Charge key”.

POSITIONING AND INSTALLATION

Do not position the machine where water jets are used for cleaning (e.g. large kitchens, etc.). The machine should be placed away from heat sources.

The machine equipped with the cash box fully filled with coins, weights 37 kg. (the weight of the coin acceptor and the bill acceptor is not included).

It is, therefore, necessary for the supporting structure (e.g. wall) and the setting wall anchors be suitable to hold the weight of the machine. This is to guarantee that there will be no collapses or dangerous conditions.

THE MANUFACTURER DECLINES ALL RESPONSIBILITY FOR ANY DAMAGE CAUSED BY UNSUITABLE INSTALLATION OR BY THE COLLAPSING OF THE SUPPORTING STRUCTURE.

WARNING

Installation and the following maintenance operations should be carried out by qualified personnel only, who are trained in the correct use of the machine according to the standards in force.

The integrity of the machine and its conformity with the rules and regulations in force for its relevant systems must be checked by qualified personnel at least once a year.

INSTALLATION

Choose the installation position and mark on the supporting structure the 4 fixing points according to the drawing below (Fig. 2).

Prepare the holes for the screws or the wall anchors and then fix the machine taking care not to damage it.

Fig. 2

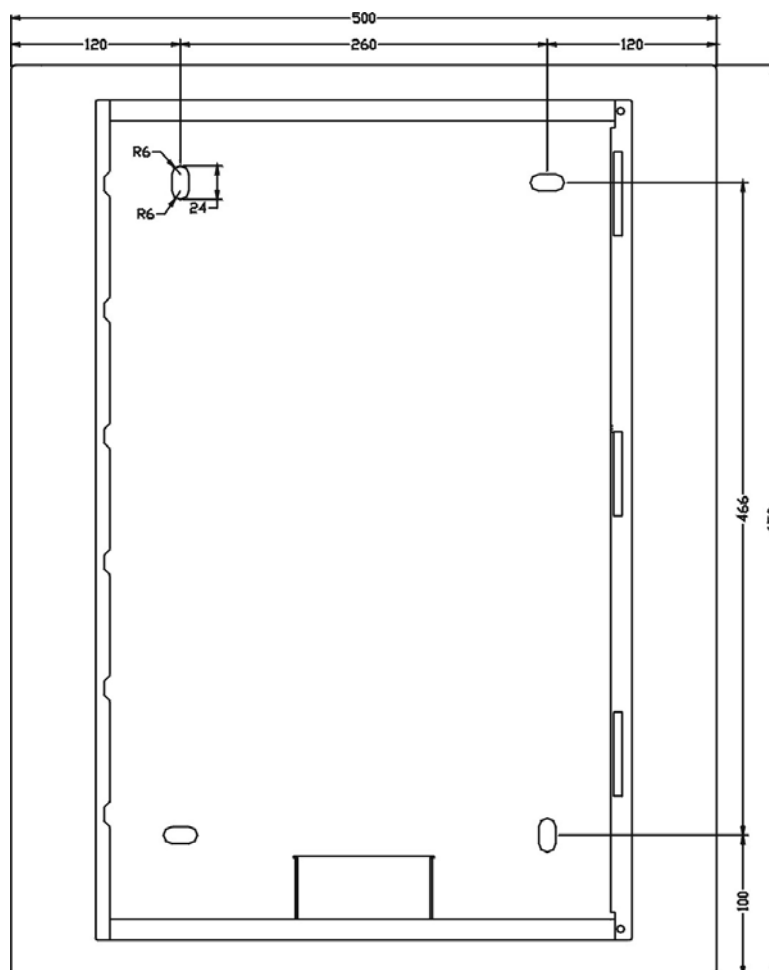

ELECTRICAL CONNECTION

⚠ WARNING

The connection should be carried out with the machine not energised and by qualified personnel only, who are trained in the correct use of the machine according to the standards in force.

The machine is a class 1 and the electrical safety is ensured only when it is correctly earthed according to the safety standards in force.

This fundamental safety requirement must be duly verified, and if in doubt, the system must be carefully tested by qualified technicians.

THE MANUFACTURER DECLINES ALL RESPONSIBILITY FOR ANY DAMAGE CAUSED BY NON-COMPLIANCE WITH THE ABOVE MENTIONED PRECAUTIONS.

1. Remove the security box cover (Fig. 3a);

Fig. 3a

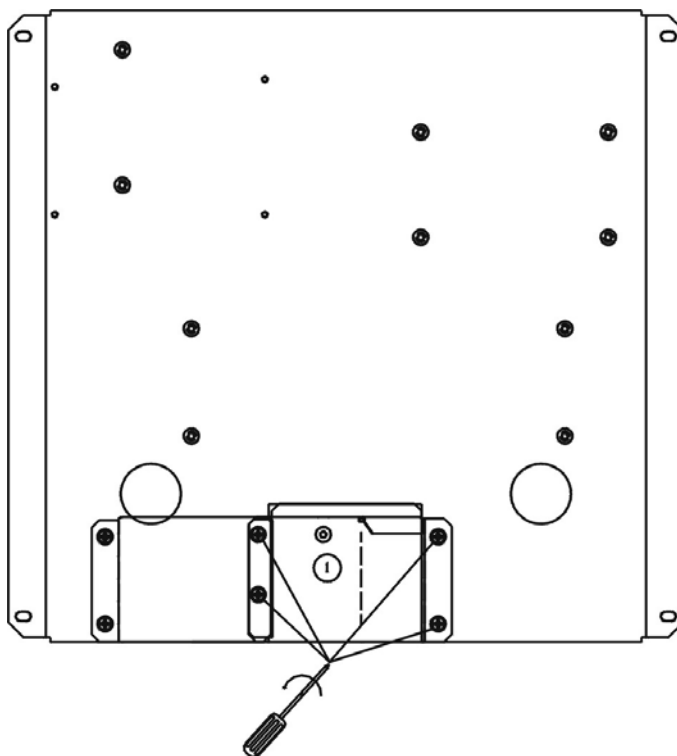

2. Connect the power supply cable (Fig. 3b);

Fig. 3b

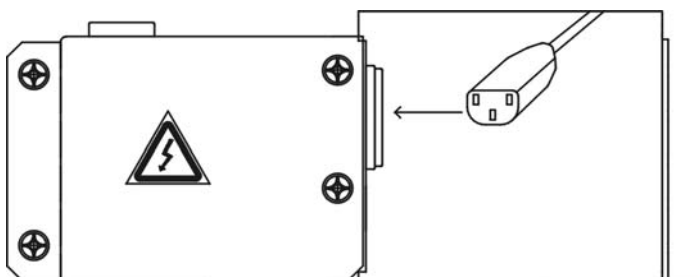

3. Fix the security box cover making sure that all the screws are tightly closed;
4. Switch to ON the switch inside the unit.

⚠ WARNING

Before carrying out any work on the equipment (with the exception of collecting the banknotes and programming), disconnect the electrical power supply plug.

VARIABLE COMBINATION LOCK

The lock is supplied with one silver colour key to be used for normal opening and closing. The lock can be customised by using a kit, available as accessory, which permits the combination of the lock to be changed.

This kit includes a change key (black) for the current lock combination as well as the change (gold) and use (silver) keys for the new combination.

Sets of change and user keys with other combinations can be supplied on request.

Additional sets of use keys (silver) may be requested, indicating the combination stamped on the keys.

Generally, only the use key (silver) is used, while the combination change keys (gold) can be kept as spares.

Do not use the change key for normal opening, as it may damage the lock.

To change combination do as follows (Fig. 4):

- Open the machine door to avoid forcing the rotation;
- Lightly lubricate the inside of the lock with a spray;
- Insert the current change key (black) and rotate to the change position (reference notch at 120 °);
- Remove the current change key and insert the change key (gold) with the new combination;
- Rotate to the close position (0°) and remove the change key.

The lock will now have the new combination.

The keys with the old combination can not be used for the new combination.

Fig. 4

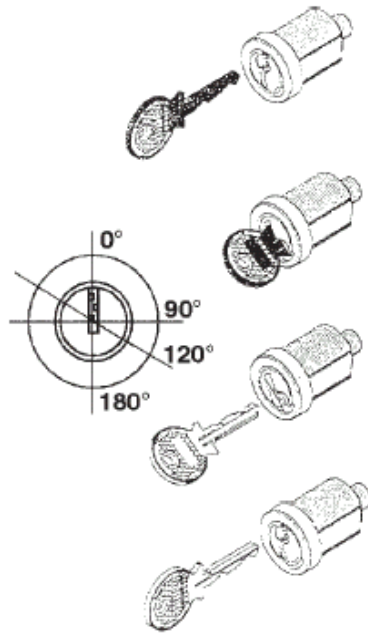

VARIABLE COMBINATION LOCK (OPTIONAL)

An extra lock can be installed in order to block the opening mechanism (Fig. 5).

Fig. 5

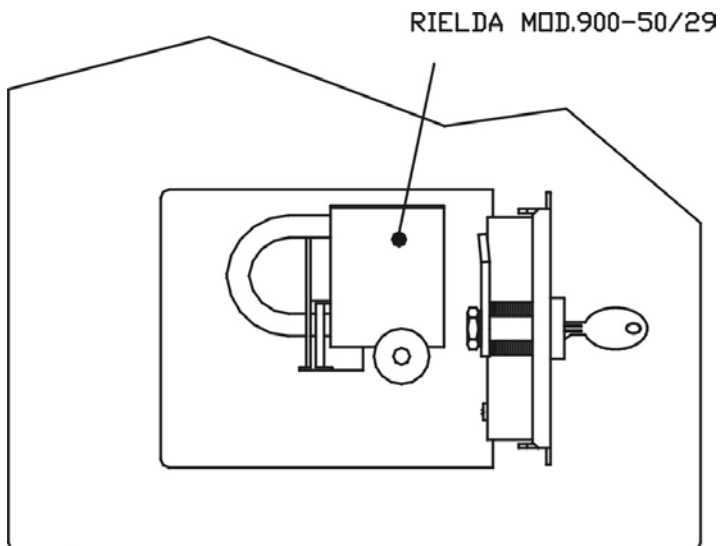

You are strongly advised to make use of this opportunity in order to increase the security of the machine.

In order to use only one key (for the standard lock and for the optional lock), we suggest to use a variable combination lock that can be personalised with the same code and method mentioned in the previous chapter.

The optional lock can be order through RIELDA.

BANKNOTE / COIN ACCEPTORS

▪ Banknote Acceptors.

Makes it possible to fit the following Acceptors:

- Global Payment Technology mod. Aurora III (required an optional kit consisting of plate and cable);
- Eureka;
- Smiley mod. NV5 (required an optional cable code 958932);
- Smiley mod. NV7.

Assembling Banknote Acceptor Global Payment Technology mod. Aurora III

First step:

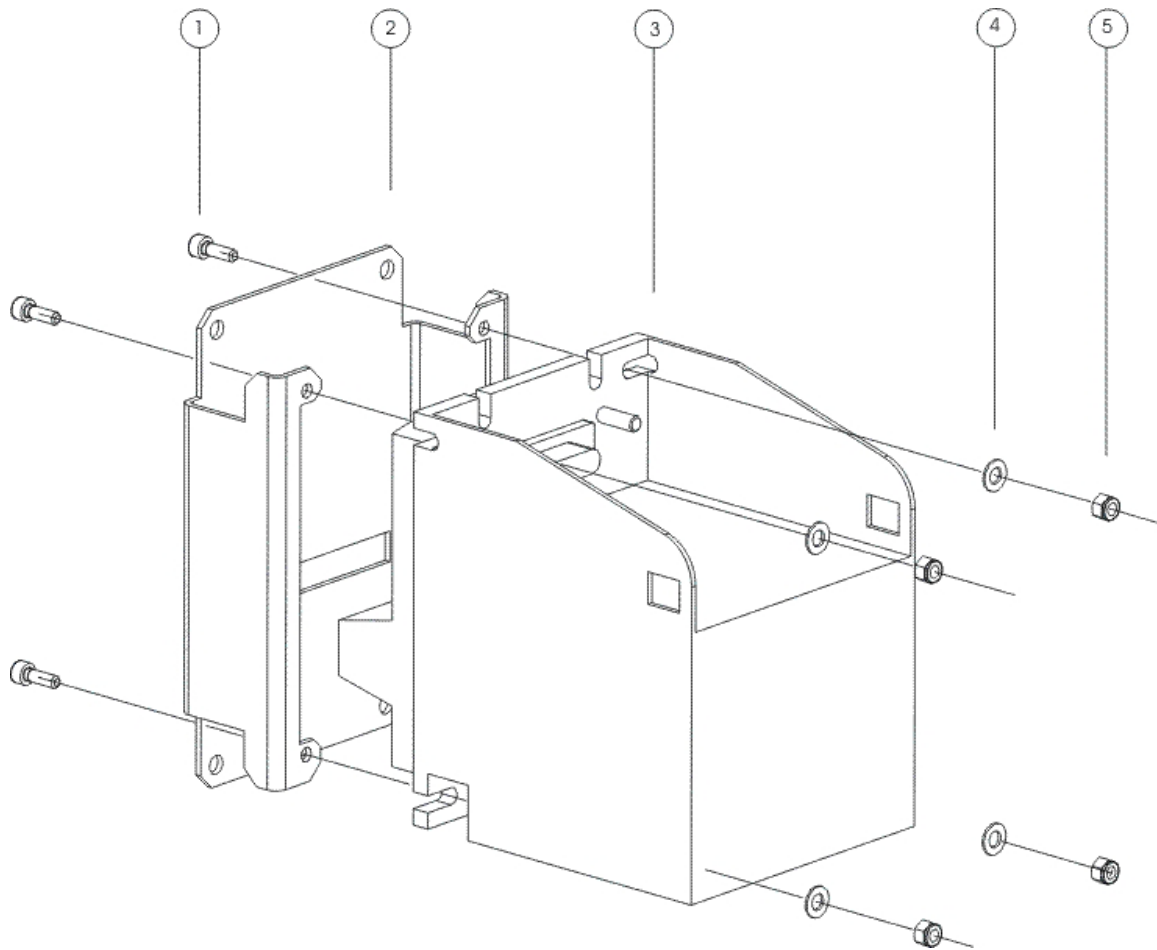

Reference	Components	Quantity
1	Bolt M4 x 12	4
2	Plate for banknote Acceptor (optional kit)	1
3	Banknote Acceptor GPT Aurora III	1
4	Washer D.i. 4.2 mm , D.e. 8.8 mm	4
5	Nut M4	4

Second step:

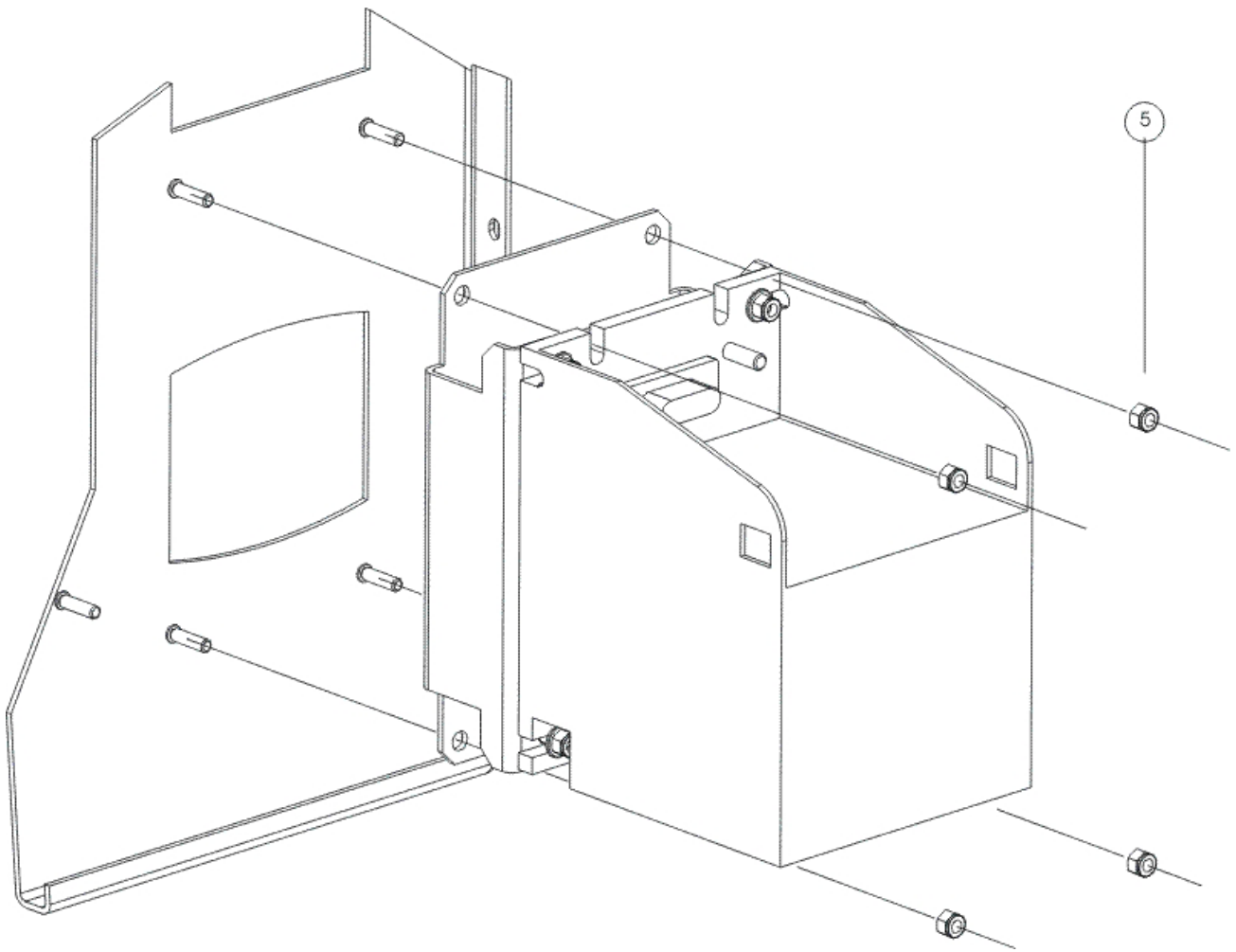

Reference	Components	Quantity
5	Nut M4	4

Third step:

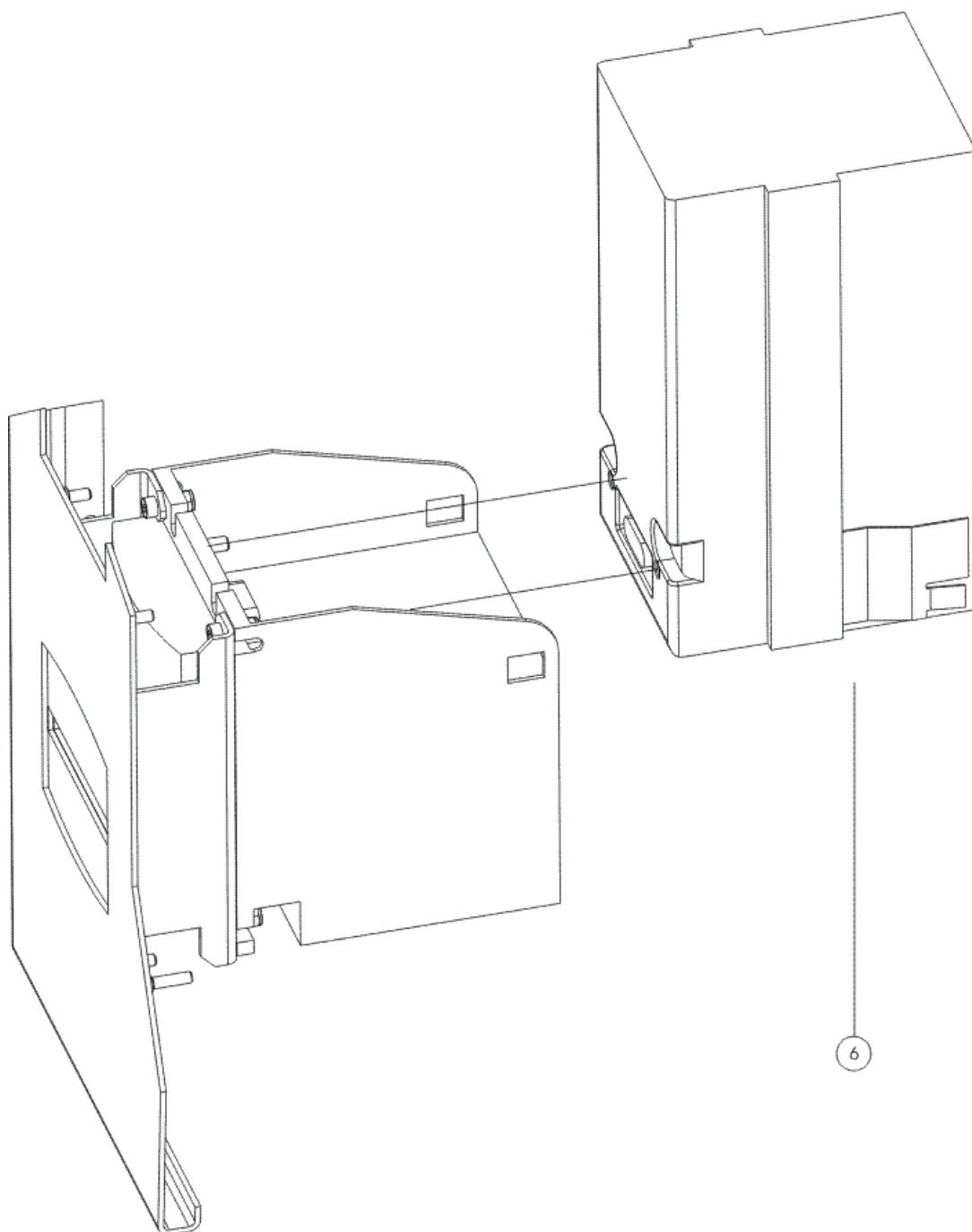

Reference	Components	Quantity
6	Stacker GPT Aurora III	1

Assembling Banknote Acceptor EUREKA

First step:

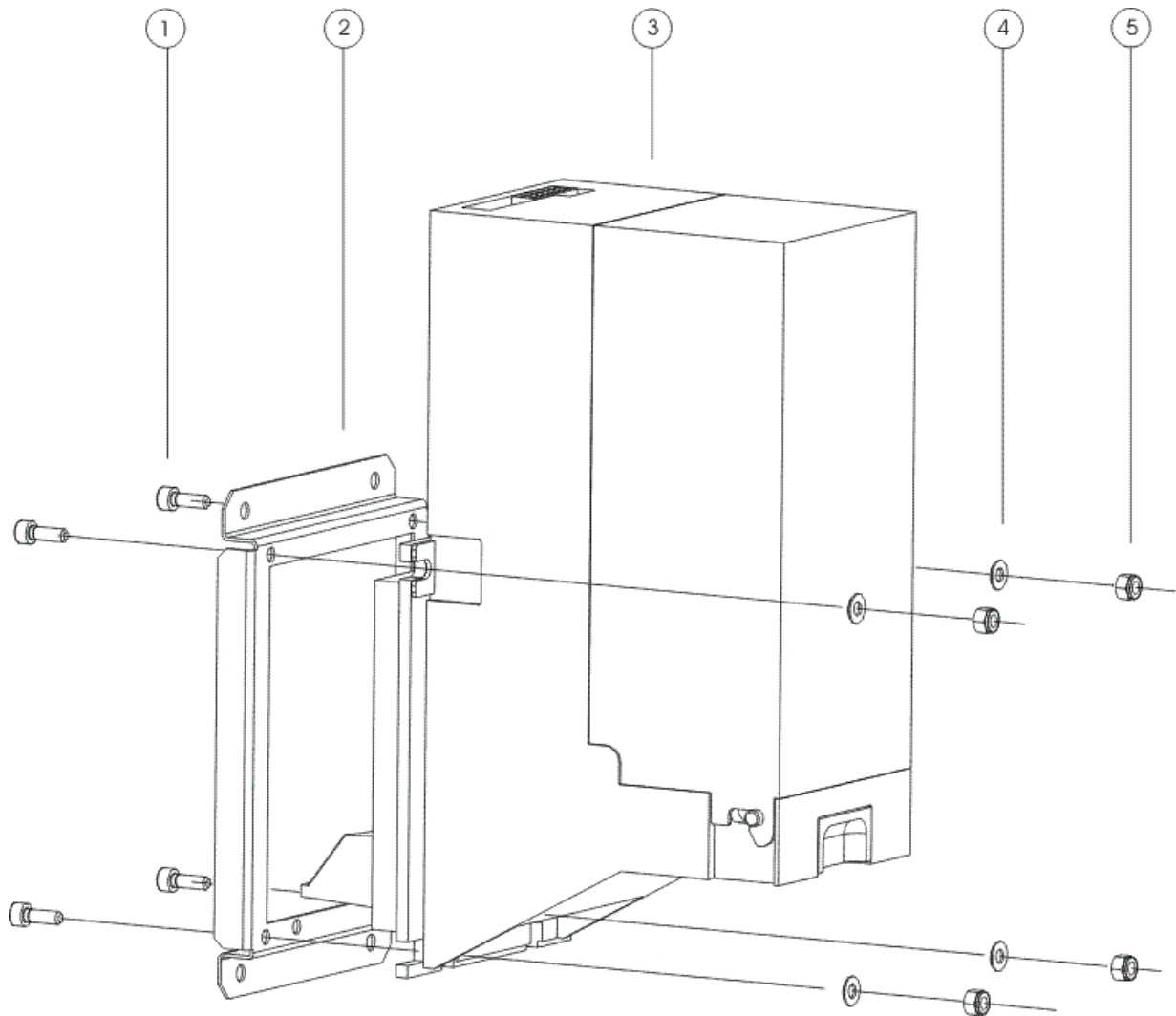

Reference	Components	Quantity
1	Bolt M4 x 12	4
2	Plate for anknote Acceptors (supplied with the Revaluation Unit)	1
3	Acceptor Eureka	1
4	Washer D.i. 4.2 mm , D.e. 8.8 mm	4
5	Nut M4	4

Second step:

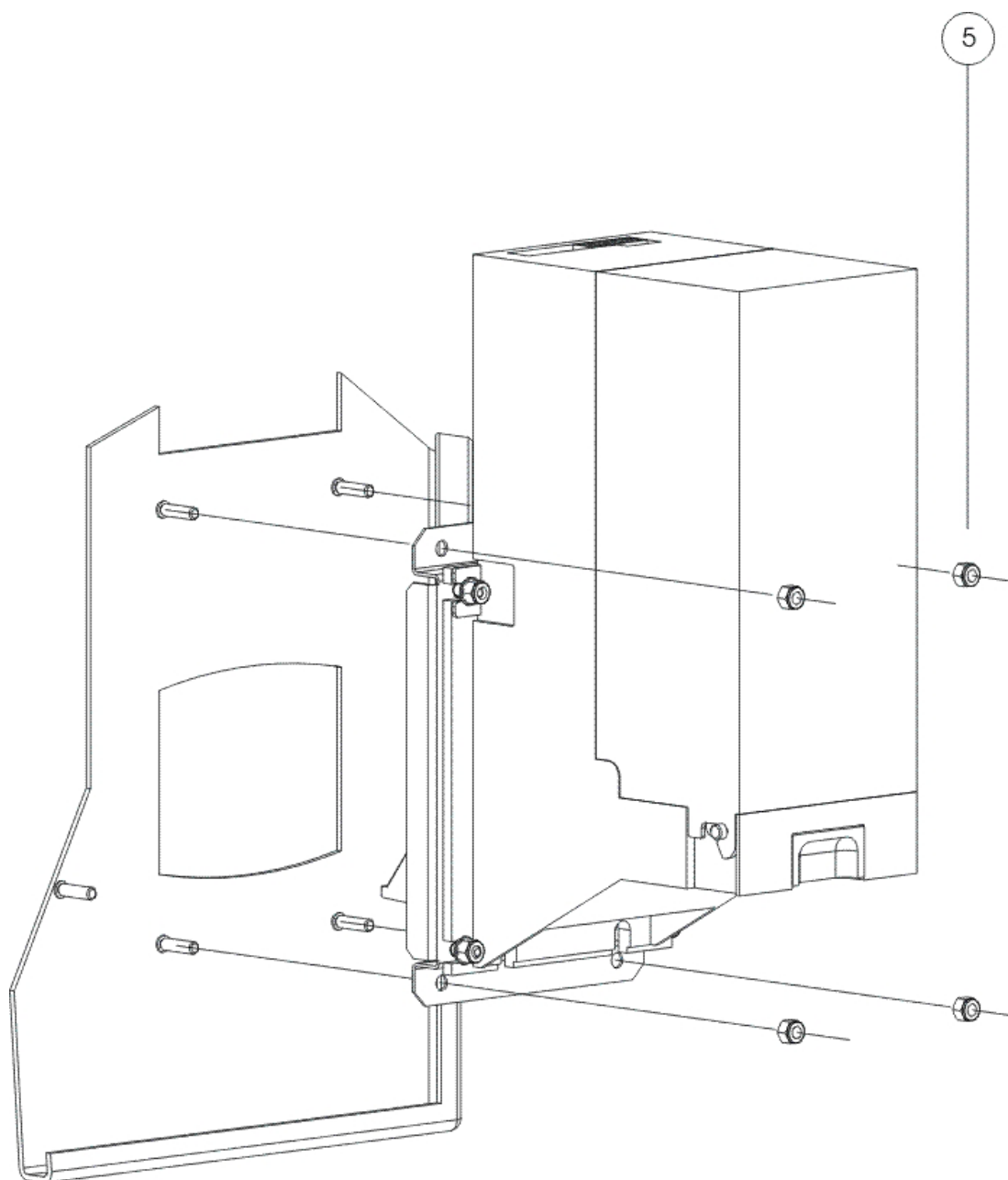

Reference	Components	Quantity
5	Nut M4	4

Assembling Banknote Acceptor SMILE NV5

First step:

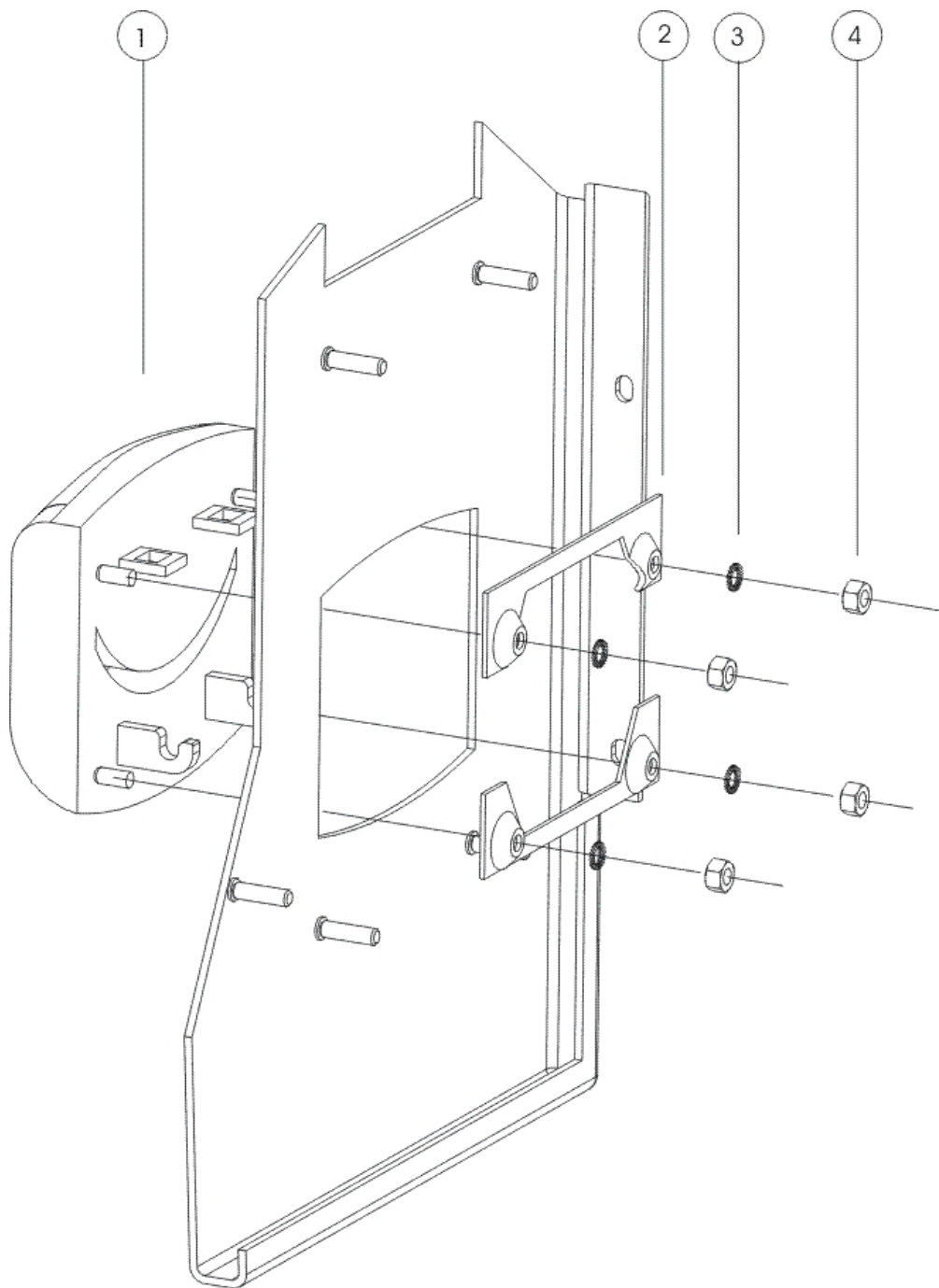

Reference	Components	Quantity
1	Frontal plate NV5 (supplied with NV5)	1
2	Plates for Acceptor (supplied with NV5)	1
3	Washer (supplied with NV5)	4
4	Nut (supplied with NV5)	4

Second step:

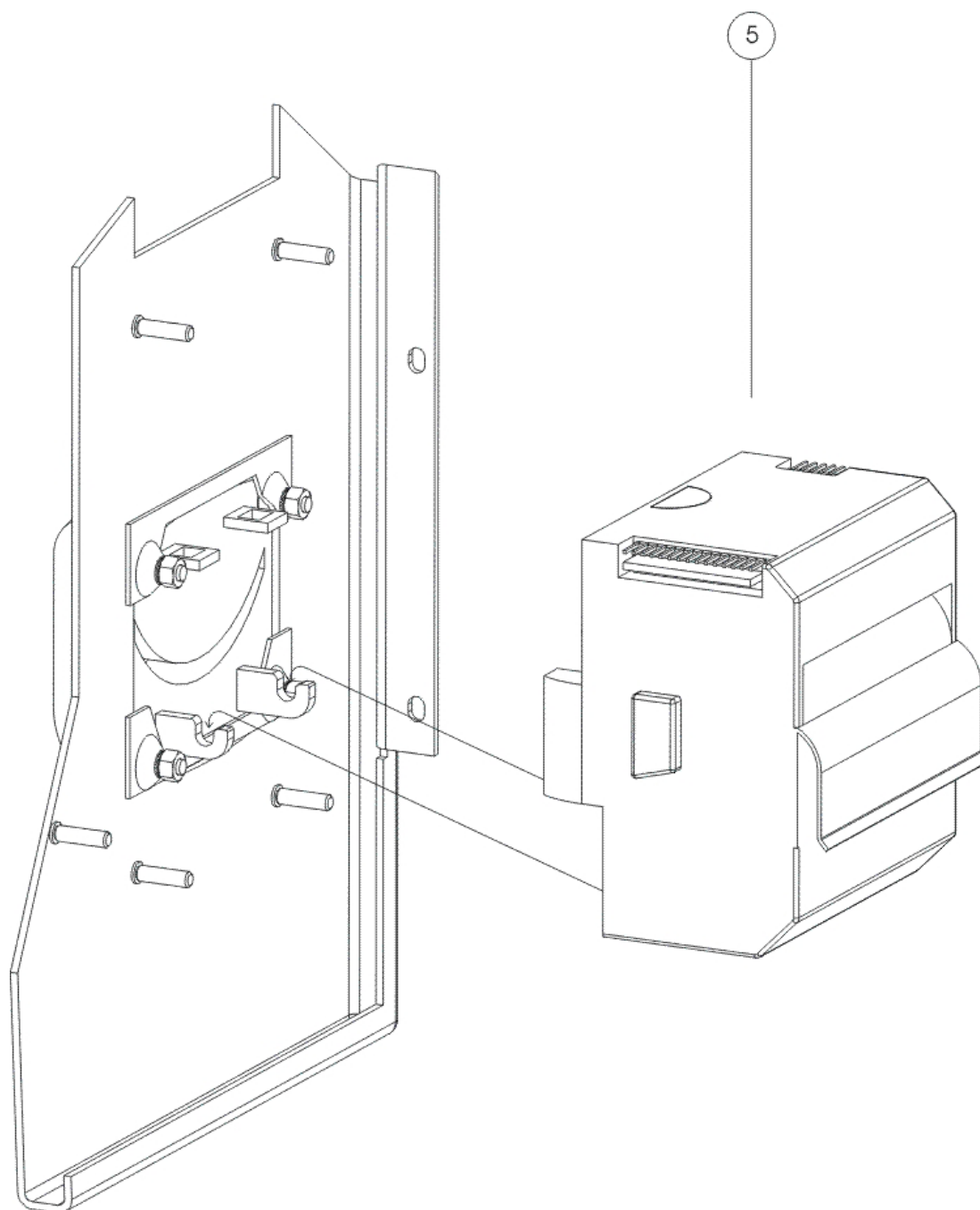

Reference	Components	Quantity
5	Banknote Acceptor NV5	1

Assembling Banknote Acceptor SMILE NV7

First step:

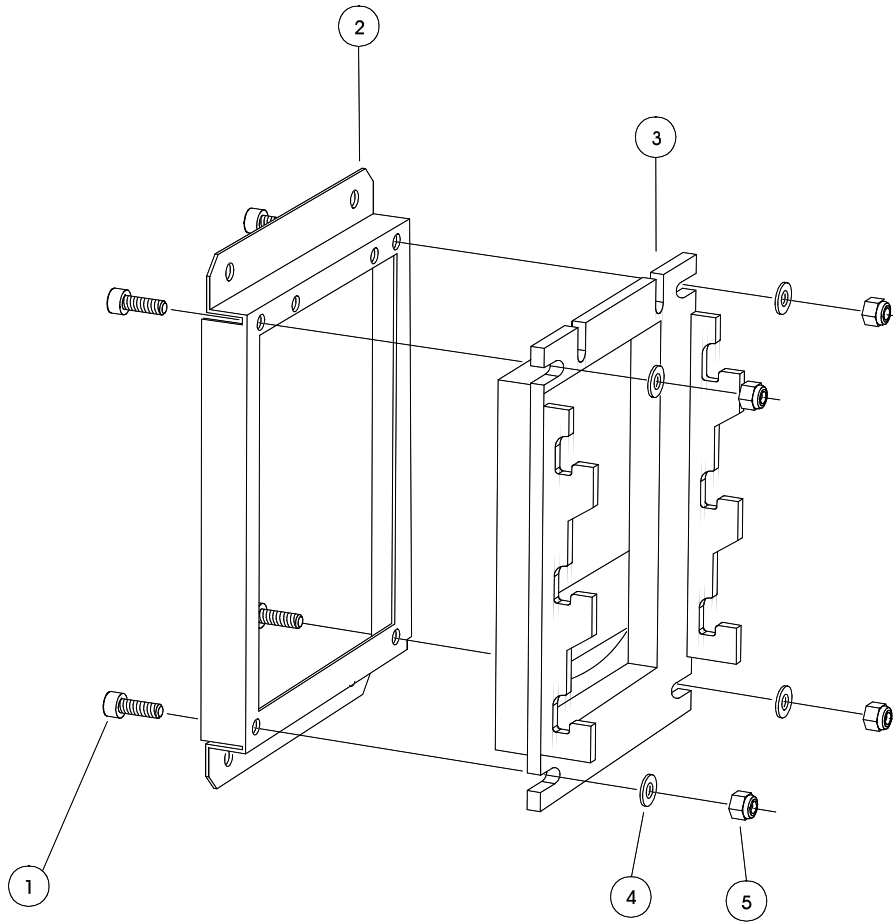

Reference	Components	Quantity
1	Bolt M4 x 12	4
2	Plate for banknote acceptors (supplied with the Revaluation Unit)	1
3	NV7 Plate (supplied with NV7)	1
4	Washer I.D. 4.2 mm , E.D. 8.8 mm	4
5	Nut M4	4

Second step:

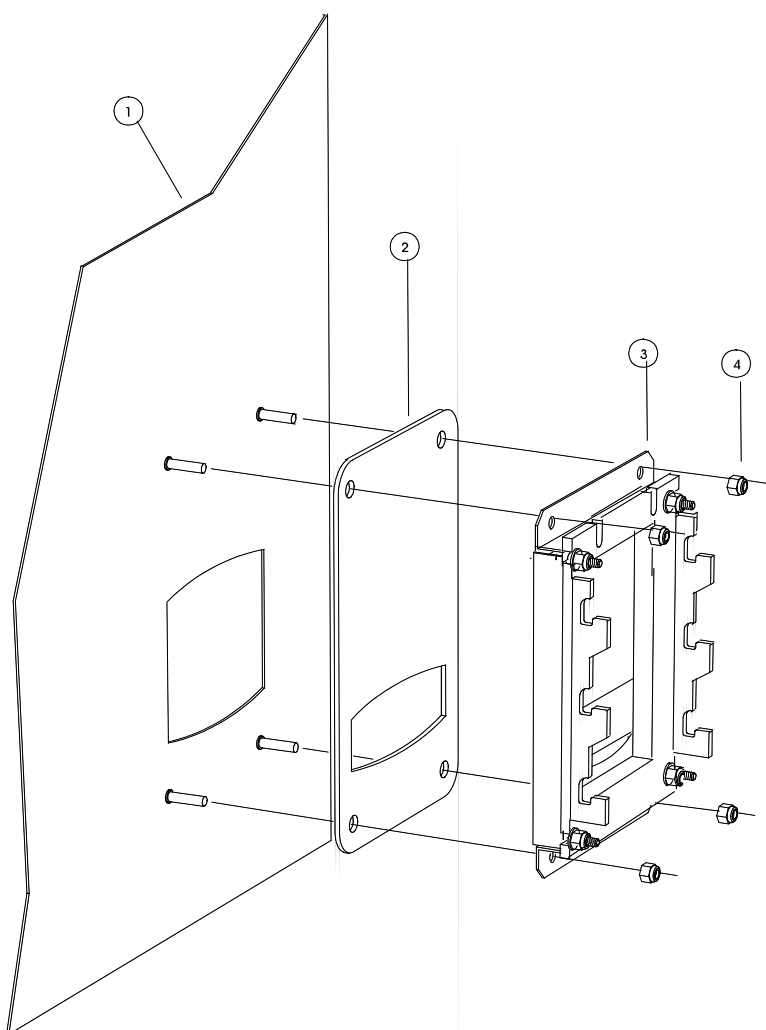

Reference	Components	Quantity
1	Revaluation Unit Door	1
2	Protection plate for NV7 (supplied with the Revaluation Unit)	1
3	Assembled component obtained from step 1	1
4	Nut M4	4

Third step:

Fix the Banknote Acceptor as indicated in the picture below:

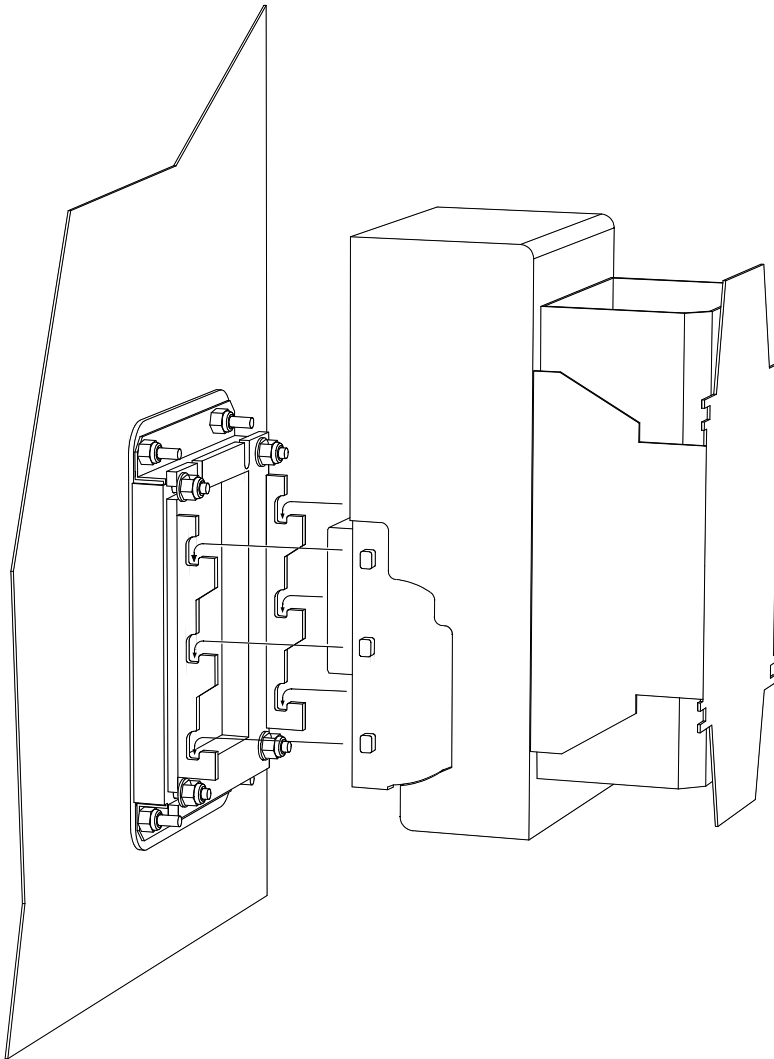

▪ **Coin Acceptors.**

Makes it possible to fit the following acceptors:

- NRI mod. G13;
- Money Control mod. SR3;
- SECI mod. RM5.

PROGRAMMING

Connect the Programming Terminal to the D type connector (9-pole female) inside the device (CPU module) and program the system as follows:

1. Program the menu "EURO", "EURO = OFF".
2. Program the menu "MACHINES", "CHARGER KEYS", "BY CASH".
3. Depending on the Acceptor used (banknotes or coins) proceed as follows:

Banknote Acceptors

- a) Program the menu "COINS", "VALIDATOR = DISABLED".
- b) Program the menu "BILLS", "ACCEPTOR": "ONLY RECHARGING", or "RECHARG. AND SALE" depending on whether you want the machine to accept the banknotes only when the key is inserted, or always.
- c) Program the menu "BILLS", "ACCEPTOR TYPE": "PARALLEL GPT" for Aurora III, or "PARALLEL ITALY" for Eureka, or "SMILE" for NV7 and NV5.

d) Set the values of the banknotes, in Euro cents, leaving the field you don't use at zero.

For GPT Aurora III: "BILL 1" = 0
"BILL 2" = 1000 (10 EURO)
"BILL 3" = 0
"BILL 4" = 500 (5 EURO)

Coin Acceptors

- a) Program the menu "BILLS", "ACCEPTOR = DISABLED".
- b) Program the menu "COINS", "VALIDATOR": "ONLY RECHARGING", or "RECHARG. AND SALE" depending on whether you want the machine to accept the coins only when the key is inserted, or always.
- c) Program the menu "COINS", "VALIDATOR TYPE": "STANDARD".
- d) Set the values of the coins, in Euro cents, leaving the field you don't use at zero.
- e) If you programmed "VALIDATOR": "RECHARG. AND SALE", program the menu "MACHINES": "RECHARGING VALUE" with a value equal to the maximum chargeable credit, without a key, before the acceptor deactivates itself.

NOTE: The programmer must always be connected and disconnected with the machine turned on.

For further information please refer to the ZIP Manual.